

# IZSVES Technical Datasheet

## Strobe Illuminator Series

Rev. F

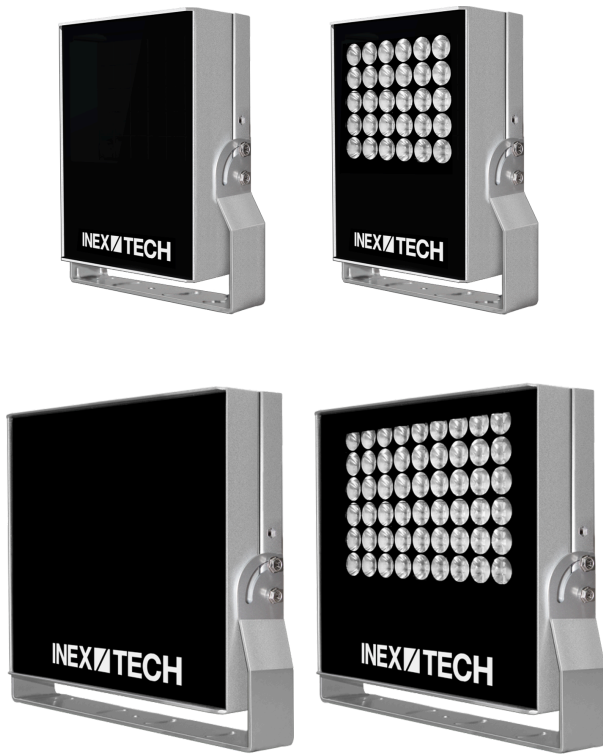

## Key Features and Benefits

- ✓ Designed for ITS and Tolling Applications
- ✓ Smart lighting technology - for optimum performance
- ✓ Works with VES All-in-one AI Camera Systems
- ✓ Single-cable and one power supply for easy installation and minimum infrastructure
- ✓ Wide temperature range - operating from -13°F to 140°F (-25°C to 60°C)
- ✓ IP66 ingress protection against extreme moisture
- ✓ NDAA Section 889 compliant



# Specifications

Item		Specification
LED Illumination	Type	High power LEDs
	Flash Activation	Activated by strobe input (3.3 - 24 VDC, opto-isolated)
	Wavelength (WVLN)	<ul style="list-style-type: none"> <li>IR = Infrared</li> <li>DR = Deep Red</li> <li>CL = Cool White (4000K)</li> <li>WL = Warm White (3000K)</li> </ul>
	Number of LEDs (N)	<ul style="list-style-type: none"> <li>1: 30 LEDs</li> <li>2: 60 LEDs</li> </ul>
	Beam Angle (HxV), degrees	<ul style="list-style-type: none"> <li>IZSVESN-WVLN-10: H10xV10</li> <li>IZSVESN-WVLN-20: H20xV20</li> <li>IZSVESN-WVLN-30: H30xV30</li> <li>IZSVESN-WVLN-H40: H40xV15</li> <li>IZSVESN-WVLN-60: H60xV60</li> <li>IZSVES2-IR-H120: H120xV20</li> </ul>
Environmental	Ingress Protection	IP66
	Operating Temperature	-13°F to 140°F (-25°C to 60°C)
	Humidity	0% to 90% RH
Certifications	EMC	FCC Part 15, subpart B; CE
	RoHS	RoHS
	Eye Safety	IEC62471: <ul style="list-style-type: none"> <li>IR wavelength models: Group 2</li> <li>DR/CL wavelength models: Group 1</li> </ul>
	NDAA	NDAA Section 889 compliant

Item		Specification																	
Physical	Dimensions (W x H x D)*	<ul style="list-style-type: none"><li>IZSVES1: 7.2 x 9.8 x 3.6 in (183 x 250 x 91 mm)</li><li>IZSVES2: 11.7 x 10.7 x 3.6 in (296 x 271 x 91 mm)</li></ul>																	
	Unit Weight*	<ul style="list-style-type: none"><li>IZSVES1: 4.2 lbs (1.9 kg)</li><li>IZSVES2: 6.8 lbs (3.1 kg)</li></ul>																	
	Material	Anodized Aluminum																	
	Color	Silver																	
Interface	Connector	Power/Strobe/Configuration: Waterproof outdoor 6+PE-pin male connector																	
	Configuration Communication Protocol	RS485																	
	Strobe Input	3.3 - 24VDC, opto-isolated																	
Power	Input Voltage	24 VDC																	
	Power Consumption (measured with 0.5 ms pulse width; 24 VDC input)	<table><tr><th>Model</th><th>Frequency (Hz)</th><th>Power (Watts)</th></tr><tr><td>SVES1</td><td>60</td><td>25W</td></tr><tr><td>SVES1</td><td>30</td><td>13W</td></tr><tr><td>SVES2</td><td>60</td><td>50W</td></tr><tr><td>SVES2</td><td>30</td><td>25W</td></tr></table>	Model	Frequency (Hz)	Power (Watts)	SVES1	60	25W	SVES1	30	13W	SVES2	60	50W	SVES2	30	25W		
		Model	Frequency (Hz)	Power (Watts)															
		SVES1	60	25W															
		SVES1	30	13W															
		SVES2	60	50W															
SVES2	30	25W																	
Accessories Included		2-axis outer pan/tilt adjustment bracket																	
		Illuminator cable, 15 ft (4.6 m)																	
Accessories Available (depending on site requirements)	Illuminator Cable	Illuminator Cable for IZSVES Illuminator ( <u>IZCAB-SVES</u> ) - different lengths																	
	Mounting hardware (in package)	<ul style="list-style-type: none"><li>Slotted steel bands with worm drive fasteners for 4" and 12" circular gantry mounting, 2 of each size</li><li>Gantry mounting bracket and screws</li></ul>																	
	Mounting hardware (packed separately)	Wall/pole/gantry mounting options																	

\* Including outer pan/tilt adjustment bracket

## Ordering Information

Product***	Available Part Numbers****	Product Description
<ul style="list-style-type: none"><li>• IZSVES1</li><li>• IZSVES2</li></ul>	<ul style="list-style-type: none"><li>• IZSVESN-WVLN-10</li><li>• IZSVESN-WVLN-20</li><li>• IZSVESN-WVLN-30</li><li>• IZSVESN-WVLN-H40</li><li>• IZSVESN-WVLN-60</li><li>• IZSVES2-IR-H120</li></ul>	IZSVES Strobe Illuminator

\*\*\* All models come with a 15 ft cable; different [IZCAB-SVES](#) cable lengths can be ordered

\*\*\*\* IZSVES[1/2]- (IR/DR/CL/WL)-10/20/30/H40/60/H120, where:

- N = 1/2 - number of LEDs: 1=30, 2=60
- WVLN = Wavelength/type of LEDs:
  - IR - Infrared
  - DR - Deep Red
  - CL - Cool White (4000K)
  - WL - Warm White (3000K)
- 10/20/30/H40/60/H120 - LED beam angle, in degrees:
  - 10 = 10x10
  - 20 = 20x20
  - 30 = 30x30
  - H40 = H40xV15
  - 60 = 60x60
  - H120 = H120xV20 (available as IZS2-IR-H120)

## Standard Package Contents

- IZSVES Strobe Illuminator with outer pan/tilt adjustment bracket
- Illuminator cable
- Mounting hardware may be included in your package, or packed separately, depending on your site's requirements.

## IZSVES1 Dimensions (mm)

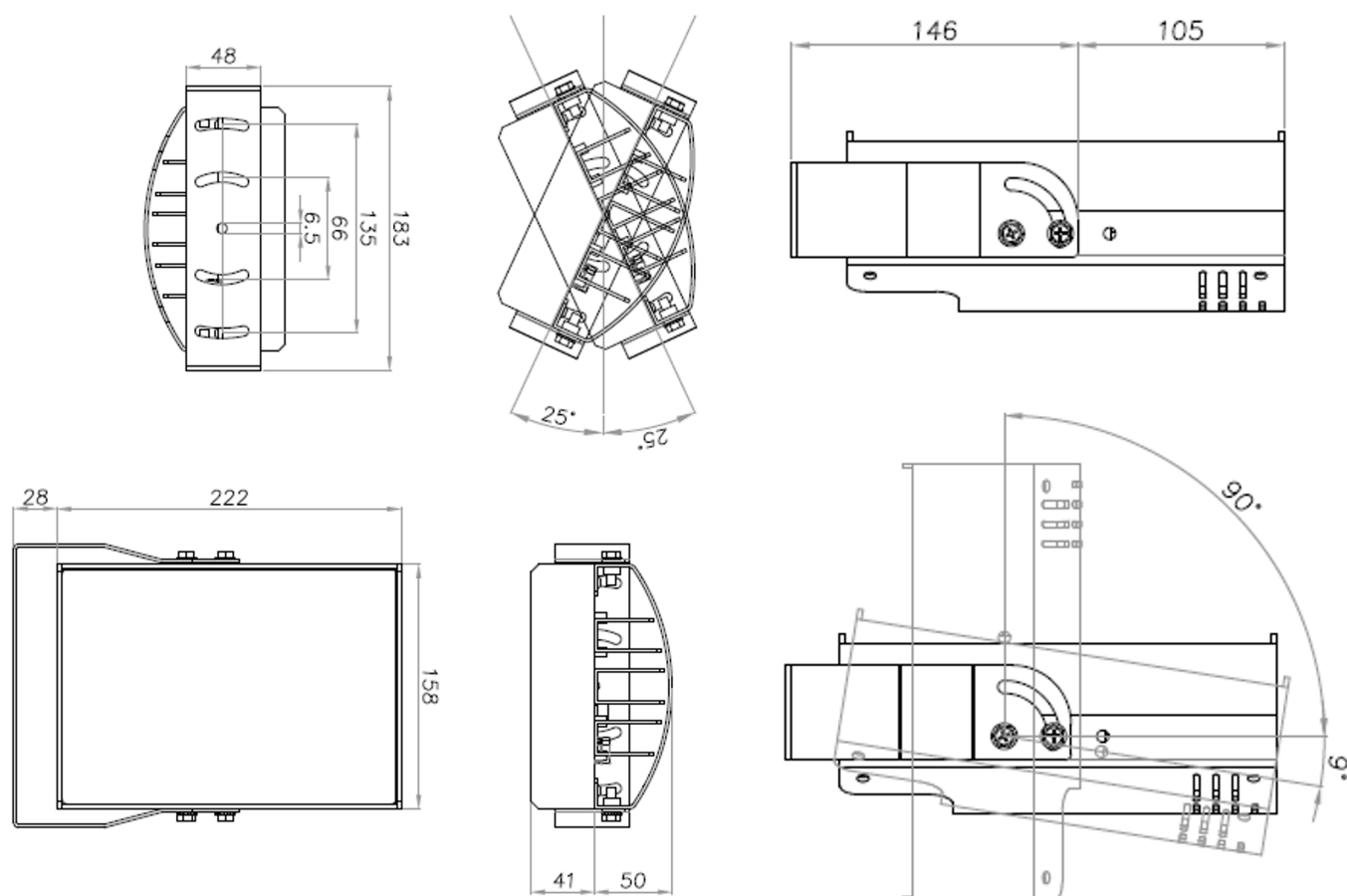

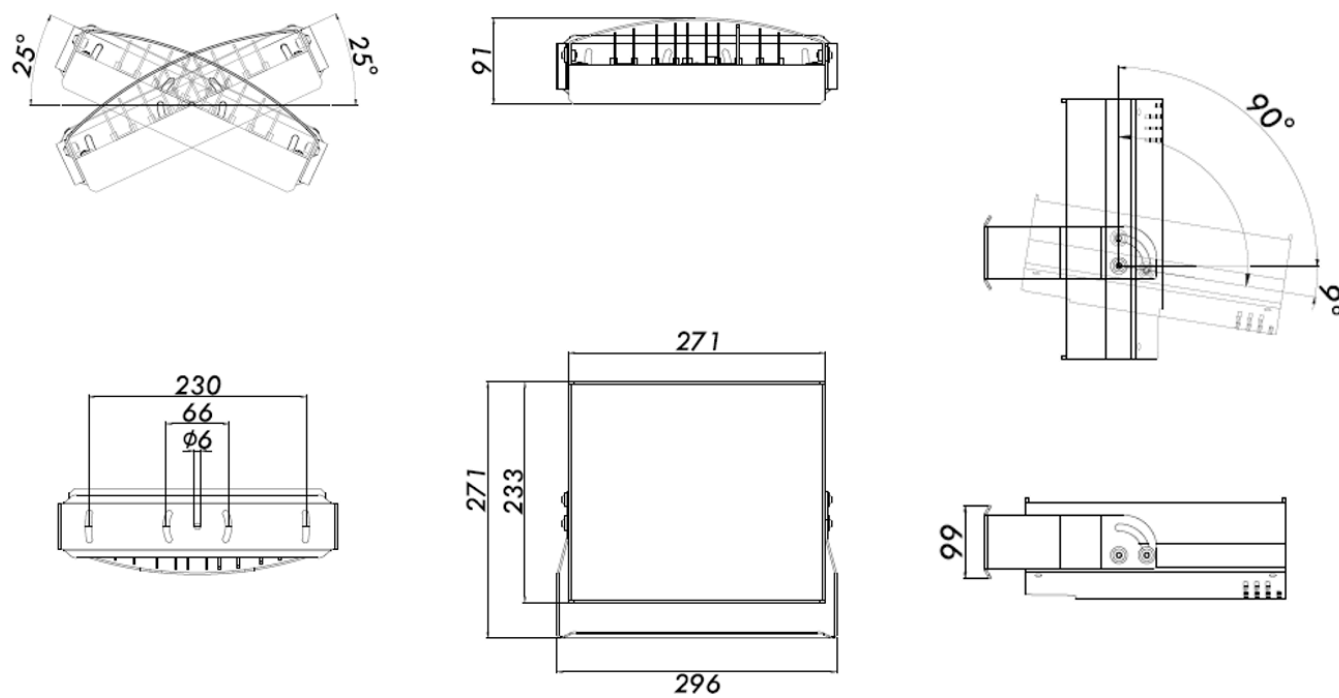

## IZSVES2 Dimensions (mm)

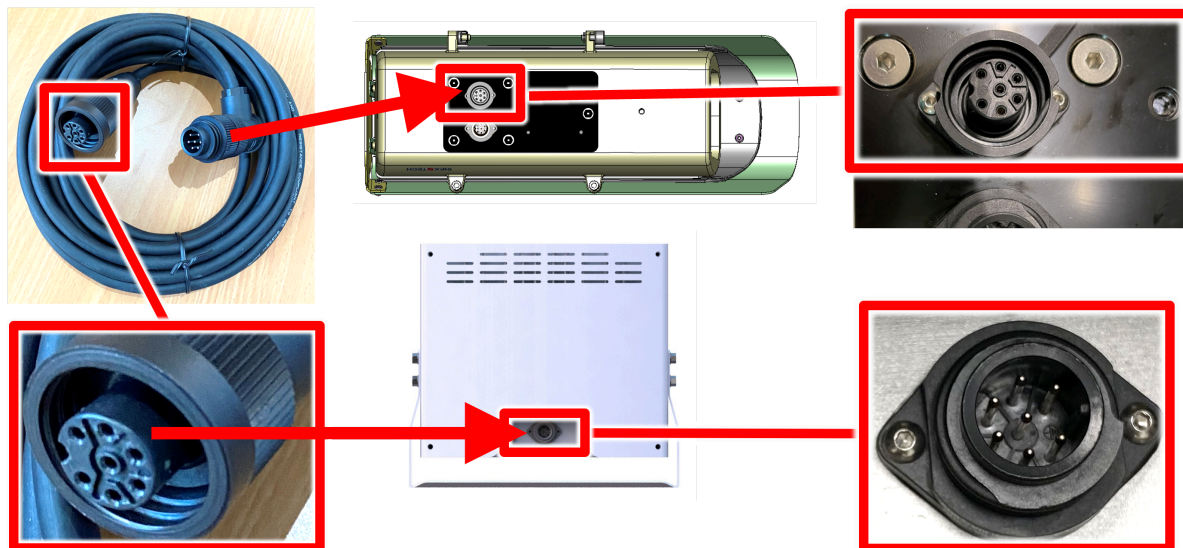

## Cable Connections and Pinouts

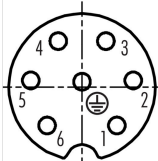
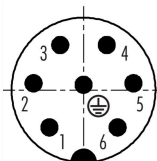
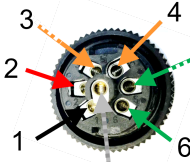
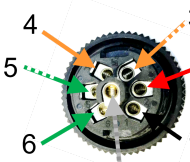

	
To Illuminator (Female)	To Camera (Male)
	
Internal Wiring	Internal Wiring

Pin	Power/Signal	Wire Color
1	GND	Black
2	+V (24 VDC)	Red
3	RS485 (B-)	White/Orange
4	RS485 (A+)	Orange
5	Strobe (-)	White/Green
6	Strobe (+)	Green
	Drain	Silver

Inex Technologies, LLC

155 Willowbrook Blvd., Suite 130

Wayne, NJ 07470, USA

+1-865-671-1400

[www.inextechnologies.com](http://www.inextechnologies.com)

[Sales@inextechnologies.com](mailto:Sales@inextechnologies.com)

[Support@inextechnologies.com](mailto:Support@inextechnologies.com)

© Inex Technologies, LLC - All rights reserved. Specifications are subject to change without notice. All third-party trademarks are the property of their respective owners.

Doc. No. IZSVES-REV-F-TDSHEET Ver. 2025-07-17

---

This page was built using the Antora default UI.

The source code for this UI is licensed under the terms of the MPL-2.0 license.